

**COMPLETE**

# **AUCTIONEERING**

**SERVICE**



## **REAL ESTATE AUCTION**

**Saturday, March 21, 2020, at 12:00pm**

**14934 Rt. 522 Beavertown, PA, Beaver Twp. Snyder County**

### **91.5+- ACRE FARM**

The Acreage is approx. 75 +- Tillable with balance in Pasture and Buildings. Located on the Property is Large Bank Barn w/Additions for Equipment Storage, Cattle Housing, Shop, & a 48' x 78' Equipment Shed. The Home is a 4 Bedroom, 2 Story having 2 Baths, Kitchen, Large Dining Room, Large Living Room, Office, & Mud/Laundry Room. Oil or Wood Heat. This Property has very good soil types and easy access to tillable acreage from Covered Bridge Road or Rt. 522. A good farm for produce with good supply of water. Contact auctioneers for showing. Terms: 10% down, balance in 60 days. No Buyer's Premium. Contact auctioneers for showing.

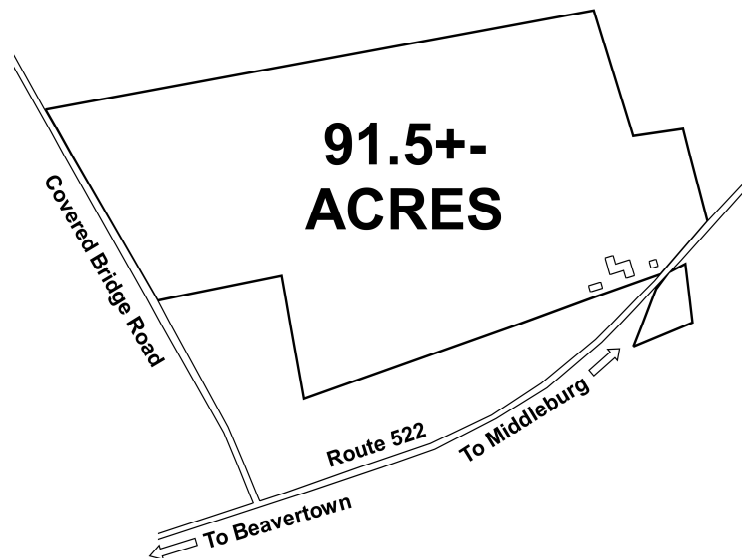

Attorney: Ax Runkle 570-837-0086

**KENNETH E. HASSINGER**

330 Hassinger Way  
McClure, PA 17841  
(570) 658-3536 : AU-001532-L



**NEIL A. COURTNEY**

3442 Heister Valley Road  
Richfield, PA 17086  
(570) 539-8791 : AU-002651-L

[www.hassingercourtney.com](http://www.hassingercourtney.com)