

**COMPLETE**

# AUCTIONEERING

**SERVICE**

## PUBLIC AUCTION

**~TWO DAY GENERATIONAL AUCTION~****Friday, April 3, 2020 at 1:00pm  
Saturday, April 4, 2020 at 9:00am****Selling Real Estate, Antiques and Collectibles, Farm Equipment and Tools  
for the Maurer Family at 150 Hebe Church Road, Herndon, PA 17830**

**Directions:** From Pillow take Market Street East toward Klingerstown. Market Street changes name to Klingerstown Road. Go about 4 miles to Hebe Church Road. Turn Left onto Hebe Church Road. Arrive at Maurer's Deer Processing on right.

**126+- ACRES OF REAL ESTATE** (Saturday 12:00pm)**Parcel #1: 125+- Acre Working Farm, 150 Hebe Church Road**

A Picturesque 125+- Acres The Acreage is 84+-Tillable with the Balance in Woodland. Located on the Property is a 2 Story, 4 Bedroom Home. On the First Level the Home has Kitchen, Dining Room Combination, Living Room, Office, Attached 2 Story Summer Kitchen as well as Open Front and Rear Porches. Located on the Property is a Large Bank Barn, a 40' x 64' Pole Building, a Building w/Cooler currently used as a Butcher Shop as well as Several Other Outbuildings. The Farm Land and Woodland has easy access with Frontage on Klingerstown Road, Hebe Church Road, and Hebe Bypass Road.

**Parcel #2: 1+- Acre, 148 Hebe Church Road**

Located on the Acreage is a 2 Bedroom Ranch Home have Large Kitchen, Dining Area, as well as Living Room, Laundry Room, Heated Breezeway, One Car Garage, and a Large Full Basement for Entertaining.

Don't miss this opportunity to purchase these exceptional properties. Contact Auctioneers for showing. Terms: 10% Down, Balance in 45 days. Possession of farm land with down payment. Possession of buildings and home at settlement. NO BUYERS PREMIUM. Attorney for Estate William Swinehart, 570-286-7777

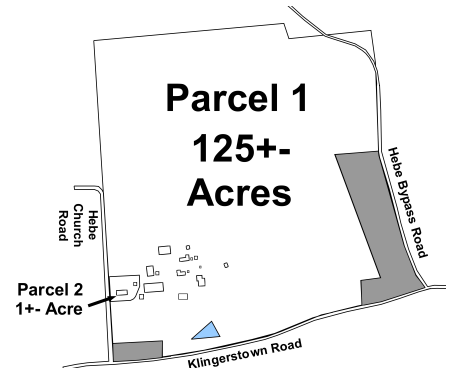
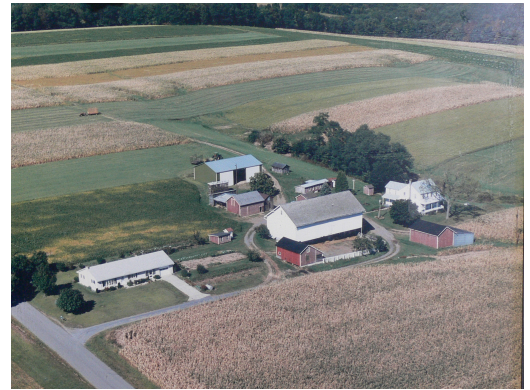
**FARM EQUIPMENT, TOOLS & RELATED** (Friday 1:00pm)

2016 Dodge Grand Caravan SXT, Flex Fuel, Gray 42,600 Miles; 2005 F150, Beige, 4x4, 31,000 Miles; 1968 F250, Red, 2 Wheel Drive, 48,000 Miles; 2015 JD Gator w/Cab; JD 6300 Diesel 4X4 w/640 Loader/ Spear, Pallet & Manure Forks; JD 325 17 H.P. Lawn Tractor; Scraper Blade; Dismantled Round Corn Crib; 20 Ft. Little Giant Elevator; Drag Elevator; JD Chisel 610 Plow; 10 Ft. Buster Bar; 3 Bottom Plow; 7 Ft. Bush Hog; Brillion Cultimulcher; JD 215 16 Ft. Disc; Hay Rake; Tedder; 4 Flat Bed Wagons, Some W/Hoists; PTO Boom Sprayer; One Horse Potato Plow; Elec Fanning Mill; International Hand Corn Sheller; Pig Feeders; Band Saw; Jig Saw; Drill Press; Grizzly Shaper; 12" Planer; Air Compressor; Lard Press; Wood Scalding Trough; Coal Fired Brooder; Stihl Rototiller; Anvil; Metal Gates; Hay Forks; New Railroad Ties; Cyclone Seeder; Ladders & Jacks; Work Bench Pump Jacks; 2-24' Aluminum Planks; Vise; Wide Variety Old Porch Posts & New & Used Building Materials; and More...

**ANTIQUES & COLLECTIBLES** (Saturday 9:00am)

Early Farm Table; Oak Dresser; Ball & Talon Parlor Stand; Tall Victrola & Records; School Seats; Kid's Wooden Wheel Wagon; Trunks; Protector Floor Safe; Tramp Art Frame; Santa Face Masks; Convertible High Chair; 2 Wood Boxes, One with Unusual Radius & Dovetail; Halloween Wood Candy Container; Barrel Jars; Early Tin Canteen & Other Tin Items; Pulleys; Wooden Ad Boxes; Barrels & Kegs; Hanging Scales; Home Made Steel Trap; Kid's Sleds; Coal Buckets; Tricycle; Old Kero Can; Butter Churns; Wood Cream Separators; Lightning Rods; Powwow Book; Tin Litho Rabbit & Cart; Washington Hotel Plate, Elizabethville; Homemade Soap; Black Salt & Pepper; Swiss Warble Bird Call; Graniteware; 1952 Elwin Schwalm Sale Bill; Egg Scales; F&S Tray; Chicken Waterers, Feeders & Nests; Sprinkle Cans; Grinding Wheel; Milk Cans; Shift Knobs; Cement Eagle; 2 Seat Farm Sled; Bob Sled; Early Loose Hay Rack Wagon & Misc. Related Parts; Early Electric Generator; Dung Fork; Mutschler Reducing Gear; Fodder Cutter; Grain Cradle; Wooden Wheels; Cast & Steel Seats; Old Hay Forks; New Holland Wood Box; Platform Scales; Single Trees & Neck Yokes; Buck & Crosscut Saws; Scythes; Bull Whip; Early Grain Mill; Yard Sticks; Candle Mold; New Idea Sign; Corn Sheller; Tin Litho Cyclist & TD18 Tractor, Die Cast; Die Cast Telephone Truck; Pressed Steel Roadster, Truck, Wagon, & Others; Allis Chalmers Record; Danville Imperial Cook Stove; Duckash Stove Match Safe; Brosius Mill Cap; Tin Types & Other Photos; 1922-34 & '41 Tin Hunting Licenses; Tiger Putty Can & Misc. Other Tins; Baskets; Lead Basket; Cast Fry Pans; Dinner Bell; Stroller; Wyandotte MD 50 BB Gun; Genealogies: Latsha, Wagner, Gearhardt, Troutman, Dunkleberger, Dietrich; Wash Board; Sewing Vise; Christmas Items; Aluminum Tree; Kid's books; Cleaver; Concave/Convex Plane; Sad Irons; Crockery Bowls; TV Light; Uncle Wiggly Game & Others; Ball Gloves; Cork Guns; Razor Back Long Bow; Recurve Bow; Delaval Separator Oil Can & Others; Depression & Carnival Glass; Crocks & Jugs; Lanterns & Lamps; Sail Ship Glasses; Bake-O-Lite Radio; East Malta and Other Milk Bottles, & Caps; Early Skates; Bear Brad Hosiery Box & Others; Canning Jars, Many Blue; Apartment Upright Freezer; Washer & Dryer; 30" Elec. Stove; Fridge; Creative Playthings Toys; Berry Scales; Old Local Advertising; Peanut Butter and Other Character Glasses; and Much More...

**60+ LOTS OF COINS To Be Sold @ 1:30 PM** (See [www.hassingercourtney.com](http://www.hassingercourtney.com) for details)

**KENNETH E. HASSINGER**  
330 Hassinger Way  
McClure, PA 17841  
(570) 658-3536 : AU-001532-L



**NEIL A. COURTNEY**  
3442 Heister Valley Road  
Richfield, PA 17086  
(570) 539-8791 : AU-002651-L

[www.hassingercourtney.com](http://www.hassingercourtney.com)